

# How to get here.

The Georgia Tech Global Learning Center is conveniently located in Midtown Atlanta at the intersection of Fifth and Spring streets in Technology Square, right off Interstate 75/85.

## Convenient Parking & Transportation

The Technology Square parking deck, attached to the Center, is accessible from Spring Street. Hourly rates range from \$1.50 for less than an hour to \$15 for the day. Our parking garage address is 770 Spring St. NW, Atlanta, GA 30308-1031.

### From the Atlanta Airport or south Atlanta (Interstate 75/85 north):

Take Interstate 75/85 north to the 10th/14th Street exit (Exit 250). Continue straight for .1 mile on Williams Street and turn right onto 10th Street. Travel .1 mile and turn right onto Spring Street. Travel approximately .4 miles on Spring Street to Fifth Street (Barnes & Noble at Georgia Tech Bookstore on your left and the Georgia Tech Hotel and Conference Center on your right), then proceed a half block farther and turn right at the next light into the parking deck. Park on the second level (blue level). From there, enter the Global Learning Center.

**From northeast or northwest Atlanta (Interstate 75/85 south)\*:** Please note there are different exit numbers on Interstates 75 & 85 South for 14th Street: Exit 84 for 85 south or Exit 250 for 75 south. The exits are both before the merge (aka The Connector). Travel to 14th Street and turn left. Travel .2 mile and turn right on Spring Street. Travel about .7 mile on Spring Street to Fifth Street (Barnes & Noble at Georgia Tech Bookstore on your left and the Georgia Tech Hotel on your right), then proceed half block farther and turn right at the next light into the parking deck. Park on the second level (blue level). From there, enter the Georgia Tech Global Learning Center.

**From east or west of Atlanta (Interstate 20):** Take Interstate 20 to Interstate 75/85 north to the 10th/14th Street exit (Exit 250). Continue straight for .1 mile on Williams Street and turn right onto 10th Street. Travel .1 mile and turn right onto Spring Street. Travel approximately .4 mile on Spring Street to Fifth Street (Barnes & Noble at Georgia Tech Bookstore on your left and the Georgia Tech Hotel and Conference Center on your right), then proceed a half block farther and turn right at the next light into the parking deck. Park on the second level (blue level). From there, enter the Georgia Tech Global Learning Center.

## Using MARTA

**Take the Red or Gold train to the Midtown MARTA station.** Then, catch the free Tech Trolley at the Peachtree Place exit out of the Midtown MARTA station. We're the first stop before the trolley enters the main Georgia Tech campus. Cross the street, go through the courtyard to enter the Center. The trolley runs every six minutes from 7:30 a.m. until 7 p.m., Monday through Friday during fall and spring semesters. For more trolley information, visit [www.parking.gatech.edu](http://www.parking.gatech.edu), then follow the Tech Trolley link.

**From the North Avenue MARTA station:** Head north on West Peachtree Street until you reach Fifth Street. Turn left onto Fifth Street and go one block. Cross Spring Street at the pedestrian crossing. You will pass the Georgia Tech Hotel and Conference Center and retail shops to reach the courtyard. Turn left and go through the courtyard to enter the Georgia Tech Global Learning Center.



### Georgia Tech Global Learning Center

84 Fifth St. NW · Atlanta, GA 30308-1031  
404-385-6203 · [www.gatechcenter.com](http://www.gatechcenter.com)

# FLOOR PLANS

The Georgia Tech Global Learning Center provides a distraction-free environment for your meeting in an independent, non-hotel facility offering flexibility for your unique meeting needs.

FIRST FLOOR

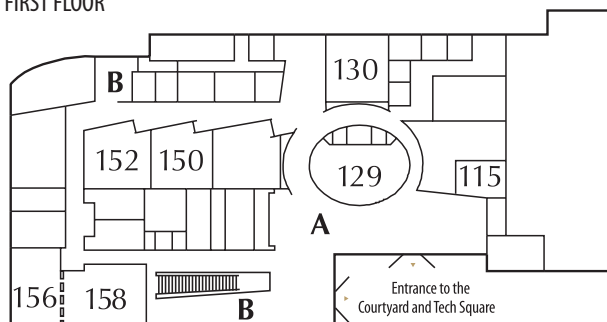

Room	Description	Capacity
129	Video Conferencing Suite	24
130	Computer Lab	28
150, 152, 156	Meeting Rooms	32/26/24*
158	Meeting Room	56*
A	Atrium/Reception Area	
B	Food Break Area	

\* Rooms 156 and 158 may be combined to accommodate 80.

SECOND FLOOR

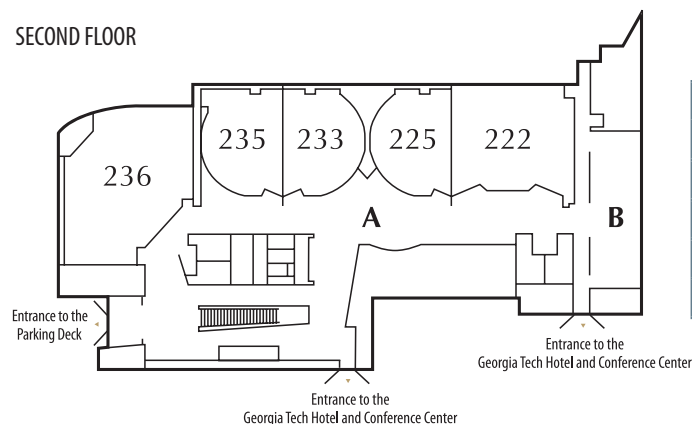

Room	Description	Capacity
222	Tiered Amphitheater	125
225, 233, 235	Tiered Amphitheaters	75
236	Tiered Amphitheater	250
A	Atrium/Reception Area	
B	Food Break Area	

THIRD FLOOR

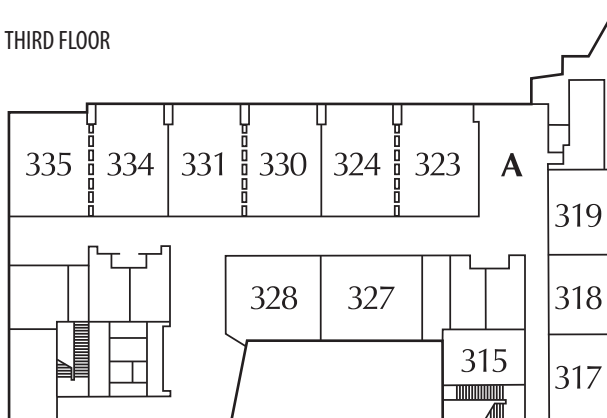

Room	Description	Capacity
315, 318, 319	Conference Rooms	16/20/20
317	Executive Board Room	14
323-324, 330-331, 334-335	Meeting Rooms	36*
327	Computer Lab	31
328	Meeting Room	36
A	Food Break Area	

\* Rooms may be combined to accommodate 72.