



INFORMATION KIT
www.gatechcenter.com



MEETINGS CONFERENCES

TRAINING

Where meeting and learning converge.

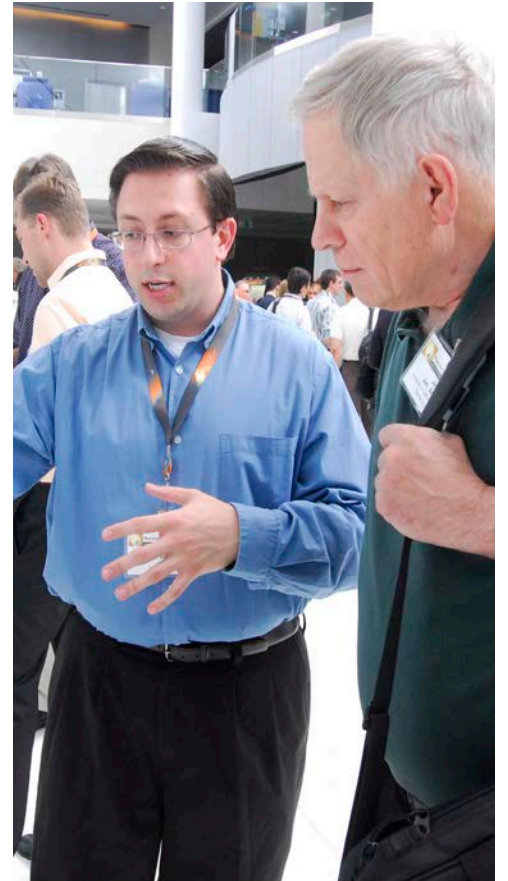



WELCOME

to the Center of it all!

The Georgia Tech Global Learning Center is the place where meeting and learning converge. Designed, staffed, and equipped with the technology to foster the relationship between learning and working, the Center is setting a new standard—and earning a global reputation—for corporate and professional meeting venues.

We call ourselves the Center, with good reason. Our building stands conveniently in the center of Atlanta's hip Midtown neighborhood. And because we're a dedicated conference center rather than a hotel, *your meeting stands at the center of our attention.*

The Center: It's what we are, where we are, and what we do.

**Georgia
Tech**  **Global
Learning
Center**

Questions? Call 404-385-6203 or visit www.gatechcenter.com

With more than 32,000 square feet of meeting and learning space, there's room to accommodate any possibility.

The Georgia Tech Global Learning Center is an International Association of Conference Centers (IACC) facility, which means we meet the stringent requirements that set us apart from other hospitality venues. The IACC is a not-for-profit, facilities-based organization whose mission is to assist members in providing the most productive meeting facilities around the world.



The Georgia Tech Global Learning Center offers:

- 5 amphitheatres seating 75 up to 250
- 8 meeting rooms for up to 36, equipped with ergonomic seats and spacious desks
- 3 dedicated conference rooms for up to 20
- 2 fully equipped computer labs seating up to 31
- 1 executive boardroom for up to 14
- Wireless technology throughout the facility
- The ability to send and receive programs worldwide from any meeting room

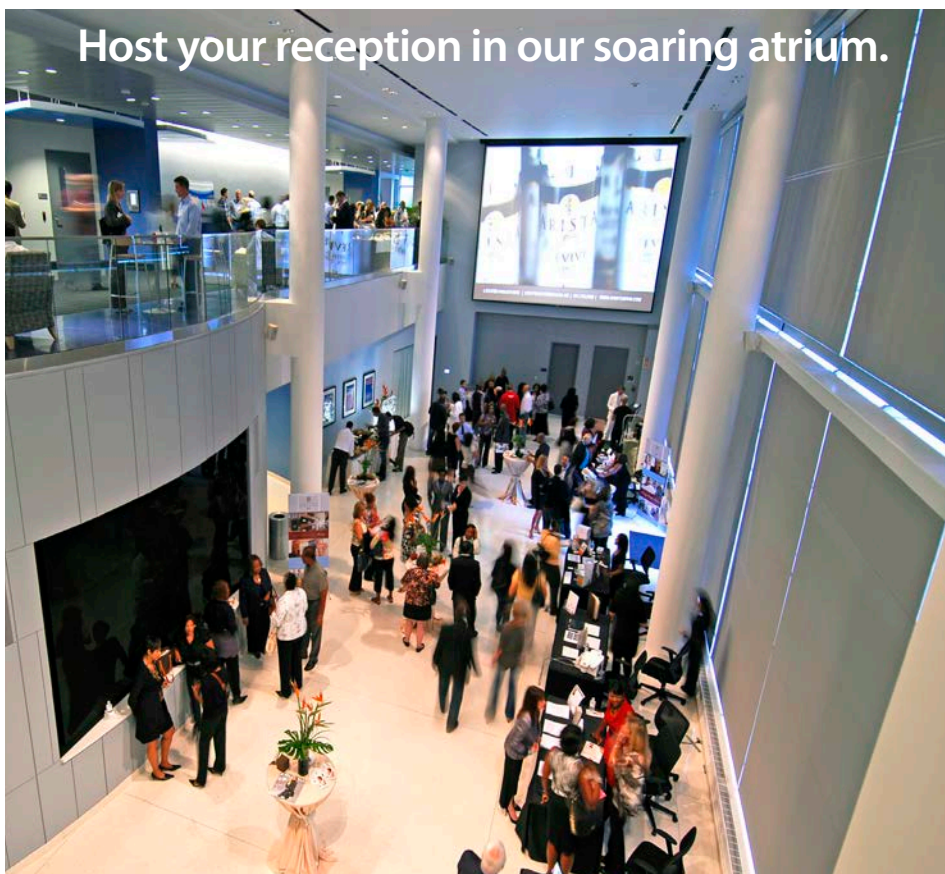

Host your reception in our soaring atrium.

We make every effort to make your meeting experience effortless.



Complete Meeting Packages:

An all-inclusive, fixed per person, per date rate for groups of any size.

Premium Tech AV Package:

Control your meeting experience at the touch of a button, including ceiling-mounted LCD projectors, drop-down screens, PCs with CD- and DVD-ROMs, and a document camera.



Our all-inclusive Complete Meeting Package offers everything you need: a distraction-free, learning-conducive atmosphere, built-in technology, flexible room arrangements, continuous refreshment service, and event and technical support from start to finish. Our state-of-the-art technology, from audio/visual systems to drop-down screens to laptop connectivity and internet access, is easy to use and adds a professional component to your event.



BuzzBreak:

With our continuous food and beverage break service, there's always a healthy snack conveniently located just a few steps away from your meeting location.

Spacious, flexible environments custom-made for meeting and learning.

ROOM	DESCRIPTION	CAPACITY
129	Video Conferencing Suite	24
130	Computer Lab	28
150, 152, 156	Meeting Rooms	32/26/24*
158	Meeting Room	56*
A	Atrium/ Reception Area	
B	Food Break Area	

*Rooms 156 and 158 may be combined to accommodate 80



Stay connected via video conferencing.

The Georgia Tech Global Learning Center provides a distraction-free environment for your meeting in an independent, nonresidential facility that offers flexibility for your unique meeting needs. The Center includes conference and meeting rooms, five amphitheatres, computer labs, and spacious reception areas designed to provide an ideal environment for your next meeting experience.

FIRST FLOOR

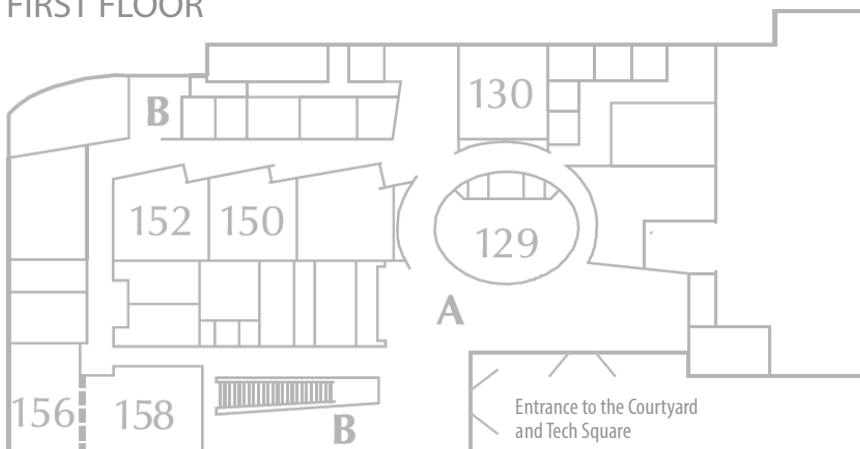

Meeting spaces that meet the highest standards in the industry.

ROOM	DESCRIPTION	CAPACITY
222	Tiered Amphitheater	125
225, 233, 235	Tiered Amphitheaters	75
236	Tiered Amphitheater	250
A	Atrium/Reception Area	
B	Food Break Area	

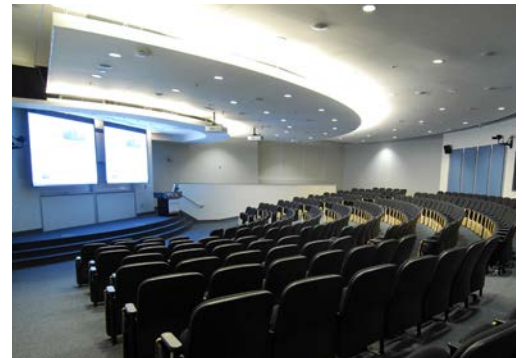

We've anticipated every detail to guarantee your meeting will be a success. Five amphitheaters with state-of-the-art audio-visual technology, continuous refreshment service, and event and technical support from our staff create an unparalleled learning experience for groups of 75, 125, or 250 people.

SECOND FLOOR

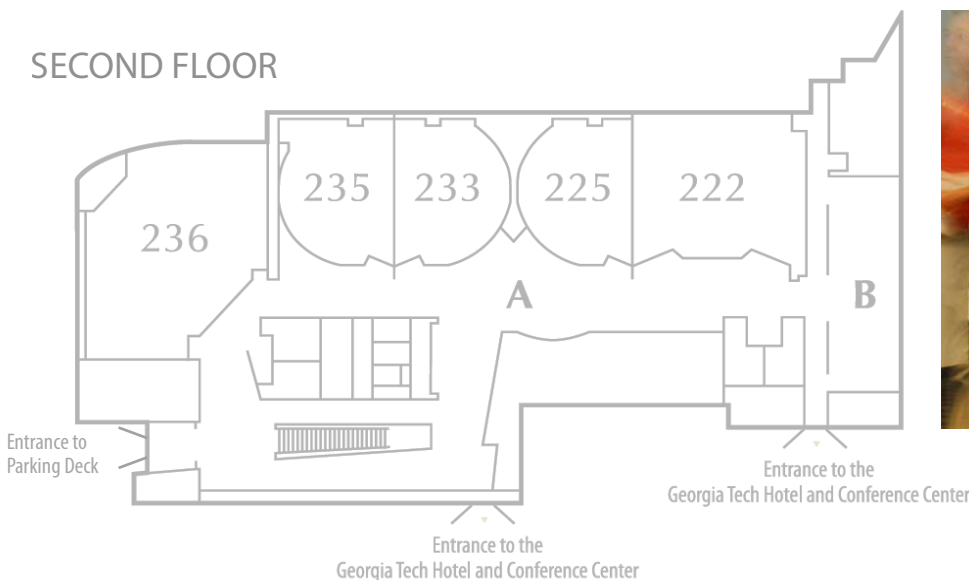

Ergonomic comfort. Ample amenities. Expert service.

ROOM	DESCRIPTION	CAPACITY
315, 318, 319	Conference Rooms	16/20/20
317	Executive Board Room	14
323-324, 330-331, 334-335	Meeting Rooms	36*
327	Computer Lab	31
328	Meeting Room	36
A	Food Break Area	

**Rooms may be combined to accommodate 72*

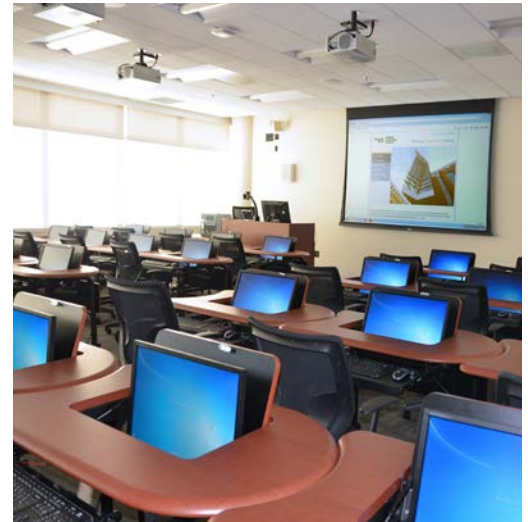

The luxurious Executive Board Room.

From your first phone call or email, you can expect courtesy, respect, and exceptional service from the Georgia Tech Global Learning Center. We employ every resource to create the perfect setting for memorable, successful meetings where corporate employees and professionals can engage together in productive learning.

THIRD FLOOR



How to get here.

The Georgia Tech Global Learning Center is conveniently located in Midtown Atlanta at the intersection of Fifth and Spring streets in Technology Square, right off Interstate 75/85.

Convenient Parking & Transportation:

The Technology Square parking deck, attached to the Center, is accessible from Spring Street. Hourly rates range from \$1.50 for less than an hour to \$15 for the day. Our parking garage address is 770 Spring St. NW, Atlanta, GA 30308-1031.

From the Atlanta Airport or south Atlanta: (Interstate 75/85 north):

Take Interstate 75/85 north to the 10th/14th Street exit (Exit 250). Continue straight for .1 mile on Williams Street and turn right onto 10th Street. Travel .1 mile and turn right onto Spring Street. Travel approximately .4 mile on Spring Street to Fifth Street (Barnes & Noble @ Georgia Tech Bookstore on your left and the Georgia Tech Hotel and Conference Center on your right), then proceed a half block farther and turn right at the next light into the parking deck. Park on the second level (blue level). From there, enter the Global Learning Center.

From northeast or northwest Atlanta (Interstate 75/85 south): Please note there are different exit numbers on Interstates 75 & 85 South for 14th Street: Exit 84 for 85 south or Exit 250 for 75 south. The exits are both before the merge (aka The Connector). Travel to 14th Street and turn left. Travel .2 mile and turn right on Spring Street. Travel about .7 mile on Spring Street to Fifth Street (Barnes & Noble @ Georgia Tech Bookstore on your left and the Georgia Tech Hotel and Conference Center on your right), then proceed half block farther and turn right at the next light into the parking deck. Park on the second level (blue level). From there, enter the Georgia Tech Global Learning Center.

From east or west of Atlanta (Interstate 20): Take Interstate 20 to Interstate 75/85 north to the 10th/14th Street exit (Exit 250). Continue straight for .1 mile on Williams Street and turn right onto 10th Street. Travel .1 mile and turn right onto Spring Street. Travel approximately .4 mile on Spring Street to Fifth Street (Barnes & Noble @ Georgia Tech Bookstore on your left and the Georgia Tech Hotel and Conference Center on your right), then proceed a half block farther and turn right at the next light into the parking deck. Park on the second level (blue level). From there, enter the Georgia Tech Global Learning Center.

Using MARTA

Take the Red or Gold train to the Midtown MARTA station. Then, catch the free Tech Trolley at the Peachtree Place exit out of the Midtown MARTA Station. We're the first stop before the trolley enters the main Georgia Tech campus. Cross the street, go through the courtyard to enter the Center. The trolley runs every six minutes from 7:30 a.m. until 7 p.m., Monday through Friday during fall and spring semesters. For more trolley information, visit www.parking.gatech.edu, then follow the Tech Trolley link.

From the North Avenue MARTA station: Head north on West Peachtree Street until you reach Fifth Street. Turn left onto Fifth Street and go one block. Cross Spring Street at the pedestrian crossing. You will pass the Georgia Tech Hotel and Conference Center and retail shops to reach the courtyard. Turn left and go through the courtyard to enter the Georgia Tech Global Learning Center.



Georgia Tech Global Learning Center

84 Fifth St. NW · Atlanta, GA 30308-1031
404-385-6203 · www.gatechcenter.com



Things to do around Technology Square.

RESTAURANTS

The Barrelhouse

22 5th St., NW
Atlanta, GA 30308
404-844-5601
www.barrelhouseatl.com

Chuck's Famous

68 5th St., NW
Atlanta, GA 30308
404-249-7733
www.chucksfamous.com

Gyro Bros

85 5th St., NW, Suite B
Atlanta, GA 30308
404-892-5707
www.gyrobros.net

Moe's Southwest Grill

85 5th St., NW, Suite C
Atlanta, GA 30308
404-541-9940
www.moes.com

Ray's New York Pizza

26 5th St., NW
Atlanta, GA 30308
404-888-9911
www.raysnewyorkpizza.com

The Spence

75 5th St., NW
Atlanta, GA 30308
404-892-9111
www.thespenceatl.com

Starbucks @ Georgia Tech Bookstore

48 5th St., NW
Atlanta, GA 30308
404-894-1858
www.starbucks.com

Starbucks

734 Spring St., NW
Atlanta, GA 30308
404-249-9204
www.starbucks.com

Subway

75 5th St., NW, Suite D-2
Atlanta, GA 30308
404-875-6768
www.subway.com

Tin Drum Asia Cafe

88 5th St., NW
Atlanta, GA 30308
404-881-1368
www.tindrumcafe.com

Umma's House

75 5th St., NW
Atlanta, GA 30308
404-477-3255

The Varsity

61 North Ave.
Atlanta, GA 30308
404-881-1706
www.thevarsity.com

Waffle House

66 5th St., NW
Atlanta, GA 30308
404-872-0028
www.wafflehouse.com

Yogli Mogli

85 5th St., NW, Suite D
Atlanta, GA 30308
404-522-2999
www.yoglimogli.com

ATMS/BANKS

Georgia Tech Hotel ATM

800 Spring St.
Atlanta, GA 30308
404-347-9440

PNC Bank

75 5th St., NW
Atlanta, GA 30308
404-897-5688
www.pnc.com

SunTrust

West Peachtree Branch
740 W. Peachtree St., NW
Atlanta, GA 30308
404-870-3120
www.suntrust.com

HOSPITAL

Emory University Hospital Midtown

550 Peachtree St., NE
Atlanta, GA 30308
404-686-4411
www.emoryhealthcare.org

RETAIL

Barnes & Noble @ Georgia Tech Bookstore

48 5th St., NW
Atlanta, GA 30308
404-894-2515
www.gatechbncollege.com

CVS

842 Peachtree St., NE
Atlanta, GA 30308
404-892-8468
www.cvs.com

Publix

The Plaza Midtown
950 W. Peachtree St., NW
Atlanta, GA 30309
404-253-3544
www.publix.com

Walmart on Campus

86 5th St., NW
Atlanta, GA 30308
Main: 404-249-0229
Pharmacy: 404-249-5007
www.walmart.com

ATTRACTIONS

Alliance Theatre

1280 Peachtree St., NE
Atlanta, GA 30309
404-733-4200
www.alliancetheatre.org

Centennial Olympic Park

265 Park Ave. West NW
Atlanta, GA 30313
404-733-4650
www.centennialpark.com

CNN Center

One CNN Center
Atlanta, GA 30303
404-827-2491
www.cnn.com/StudioTour

College Football Hall of Fame

250 Marietta St., NW
Atlanta, GA 30313
404-880-4800
www.cfbhall.com

Ferst Center for the Arts

349 Ferst Dr.
Atlanta, GA 30332
404-894-2787
www.ferstcenter.gatech.edu

Fox Theatre

660 Peachtree St., NE
Atlanta, GA 30308
404-881-2100
www.foxtheatre.org

Georgia Aquarium

225 Baker St.
Atlanta, GA 30313
404-581-4000
www.georgiaaquarium.org

High Museum

1280 Peachtree St., NE
Atlanta, GA 30309
404-733-4400
www.high.org

Margaret Mitchell House & Museum

990 Peachtree St., NE
Atlanta, GA 30309
404-249-7015
www.margaretmitchellhouse.com

SkyView Atlanta Ferris Wheel

168 Luckie St., NW
Atlanta, GA 30303
678-949-9023
www.skyviewatlanta.com

World of Coca-Cola

121 Baker St., NW
Atlanta, GA 30313
1-800-676-COKE (2653)
or 404-676-5151
www.worldofcoca-cola.com



Legend

-  Georgia Tech Global Learning Center
-  MARTA Station
-  Tech Trolley Stop
-  Tin Drum Asia Cafe
-  Waffle House
-  Chuck's Famous
-  Gyro Bros
-  Moe's Southwest Grill
-  Yogli Mogli
-  Subway
-  Umma's House
-  The Spence
-  Starbucks @ Georgia Tech Bookstore
-  Ray's New York Pizza
-  The Barrelhouse
-  PNC Bank
-  SunTrust (Branch & ATM)
-  Barnes & Noble @ Georgia Tech Bookstore
-  Georgia Tech Hotel and Conference Center
-  Walmart on Campus
-  Starbucks